

TRIM SEALS **DIRECT**

by
FSUSA
FLEXSEALS.COM

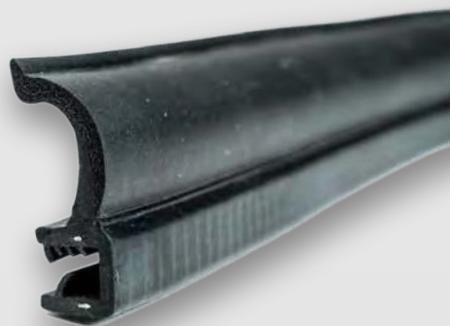

ALL PROFILES IN **STOCK** AND AVAILABLE
FOR **SHIPPING** TODAY!

**GREAT PEOPLE PROVIDING HIGH QUALITY
PARTS ON TIME, EVERY TIME.**



HOW TO ORDER

VISIT

FLEXSEALS.COM

1

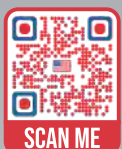

6551 Jansen Ave NE Suite 206 • Albertville, MN 55301, USA
sales@flexseals.com • [763] 777-8037 • www.flexseals.com

TABLE OF CONTENTS

INFORMATION	3-4	
TOP BULBS	5-6	
SIDE BULBS	7-8	
WIPERS	9-10	
DENSE EDGE	11-12	
LOCKING CHANNEL	13-14	
DUAL DUROMETER	15-16	
SPONGE	17-20	
EPDM EDGE TRIM	21-22	
PVC EDGE	23-24	
WHO WE ARE	25-26	

INFORMATION

TYPES OF SEALING PROFILES

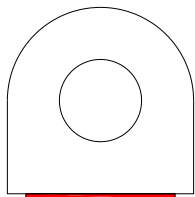

Sponge



Dense



Dual
Durometer

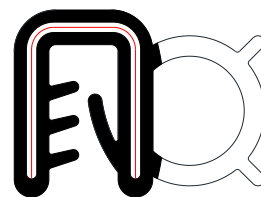

Clip-On

TYPES OF SEALING PROFILES

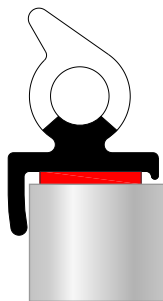

PSA/HATS

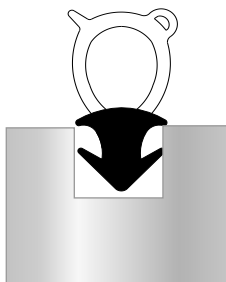

Push-In/Barb

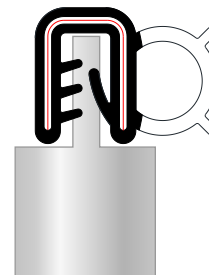

Clip-On

TYPES OF SEALING PROFILES



45° Miter cut for
90° Corner

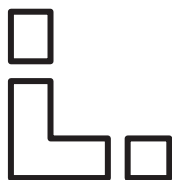

90° With Molded Corner
With Butt Joints
(Not available with
taped extrusions)

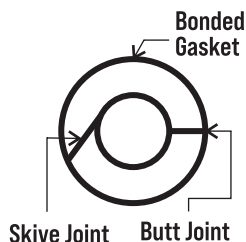

Bonded Gasket
Skive Joint Butt Joint

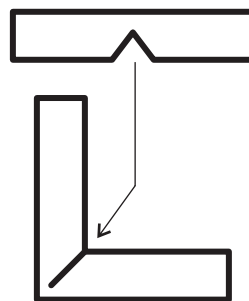

Notched 90° Corner

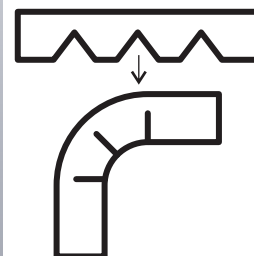

Multi-notched for
Radius Corner



PRESSURE-SENSITIVE ADHESIVE SYSTEMS



Some type of adhesive will be needed to hold your seal in place. Whether it is for temporary placement or a permanent application, different adhesive requirements will need to be met. Each surface type may require a different adhesive. Contact your FS Sales Engineer to determine the correct adhesive method for your specific application.

Generally, 3M HATS Tape is used for permanent applications where the seal is exposed to extreme environments and stresses (see diagram below). Acrylic and rubber based adhesives are normally used to hold the seal in place before the seal is more permanently attached. Acrylic and rubber adhesives are generally used in less demanding applications. Special considerations apply when bonding to irregular and low-surface energy materials (polypropylene and glass for example).

No matter what bonding surface you apply the seal to, it must be clean and free of any surface contaminants such as oils, greases, plasticizers, mold releases and dirt in general. Most bonding failures are not due to the adhesive failing, but instead the failure to properly clean the surfaces. It is also important to note that all adhesive applications will require compression when the gasket is being applied.

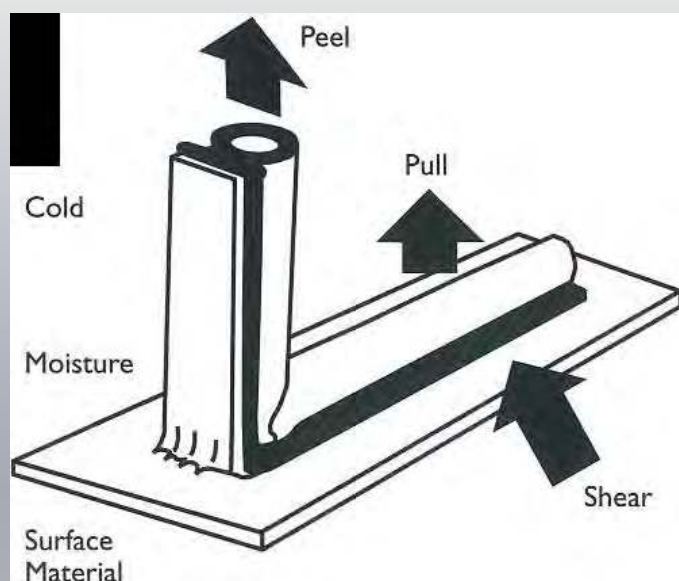

CLIP-ON INSERT SELECTION

FS USA manufactures coextruded dual, and triple durometer EPDM rubber seals with encapsulated metal inserts. Depending on the sealing application, multiple insert materials and configurations are available to meet specific performance requirements. Variables which influence insert design and configuration include bulb location, corner radii, the axis in which the seal will be mounted, shear, pull and peel forces, and flange geometry. Contact your FS Sales Engineer to select the appropriate insert for your engineered sealing profile.

STAMPED OR LANCED	INSERT MATERIAL	WIRE
	- LOW CARBON STEEL	
	- STAINLESS STEEL	
	- ALUMINUM	

Sponge: EPDM, Neoprene, Vinyl Nitrile, Silicone

Dense: EPDM, Neoprene, Nitrile, Silicone, PVC, TPE

Multiple Durometer: EPDM, Neoprene, Silicone

Clip-On: EPDM, Neoprene, Silicone

Colors: High Minimums Apply

TOP BULBS

Bulb seals are seals which can be made of various materials including EPDM, PVC, Dual durometer, etc. The bulb is placed on the top of the seal or either side. In this case, the bulb is co-extruded to the top of the seal. Bulb seals allow an edge to be covered, while having further gap reach for more challenging sealing applications. Bulb seals can be fastened to applications by being mounted, (via clip, push-in, or slide in) or adhesion via acrylic foam tape. Choose from our large selection of standard bulb seals or contact an engineer for a custom application today! We look forward to serving you!



Note: Top Bulbs are restricted in most applications to the flange being perpendicular to the sealing surface and are only recommended to turn corners in the direction shown to the right.



NOT FINDING YOUR PROFILE?

CONTACT US FOR YOUR CUSTOM DESIGN NEEDS

SALES@FLEXSEALS.COM • (763) 777-8037

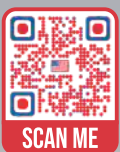

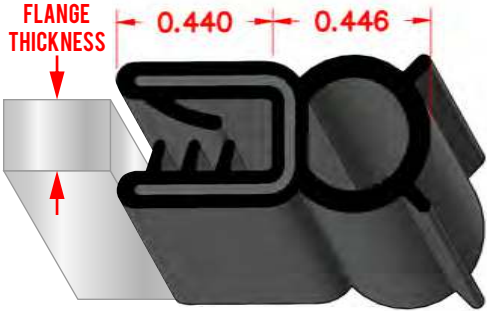
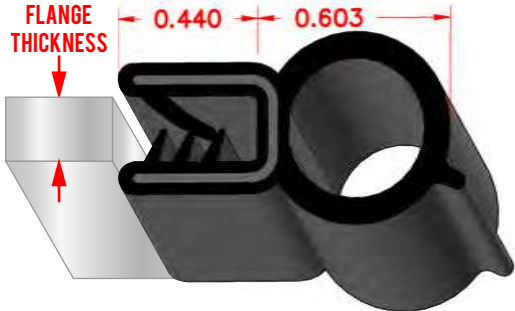
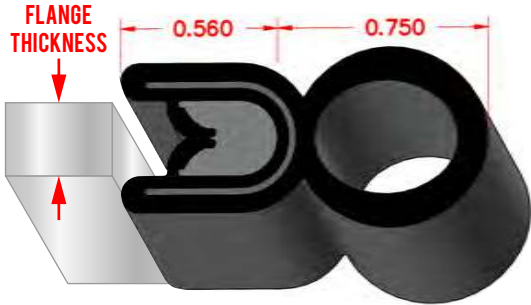
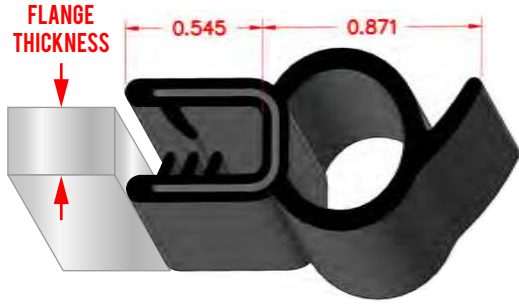
PART NO. #1197		PART NO. #1193	
			
FLANGES	1/16" - 1/8"	FLANGES	1/16" - 1/8"
PART NO. #3131		PART NO. #3175	
			
FLANGES	1/16" - 1/8"	FLANGES	1/16" - 1/8"

PROFILES IN STOCK AND READY TO SHIP TODAY!

SIDE BULBS

Bulb seals are seals which can be made of various materials including EPDM, PVC, Dual durometer, etc. The bulb can be placed on top or either side of the seal. In this case, the bulb is co-extruded on the side of the seal. Bulb seals allow an edge to be covered, while having further gap reach for more challenging sealing applications. Bulb seals can be fastened to applications by being mounted, (via clip, push in, or slide in) or adhesion via acrylic foam tape. Choose from our large selection of standard bulb seals or contact an engineer for a custom application today! We look forward to serving you!

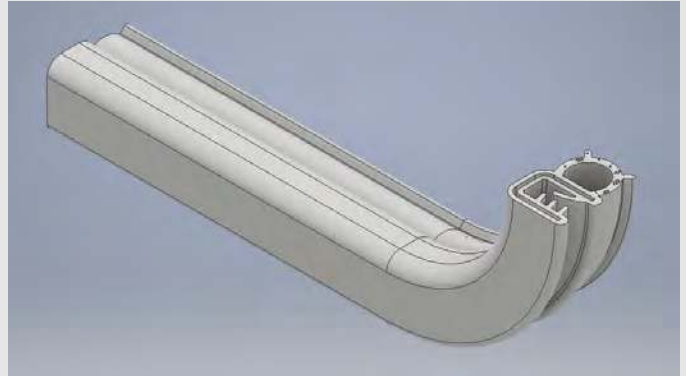

Note: Side Bulbs are restricted in most applications to the flange being parallel to the sealing surface and are only recommended to turn corners in the direction shown to the right.



NOT FINDING YOUR PROFILE?

CONTACT US FOR YOUR CUSTOM DESIGN NEEDS

SALES@FLEXSEALS.COM • (763) 777-8037



PART NO. #1198		PART NO. #3130	
			
FLANGES	1/16" - 1/8"	FLANGES	1/8" - 3/16"
PART NO. #3009		PART NO. #1741	
			
FLANGES	1/8" - 3/16"	FLANGES	1/16" - 1/8"

PROFILES IN STOCK AND READY TO SHIP TODAY!

WIPERS

A wiper seal is a specialty seal made from EPDM rubber or PVC. It creates a finished edge and seal which protects against weather and water damage. It is made by co-extruding an EPDM flap with dense edge trim and a wire carrier. A wiper seal can be used to create a soft seal on a slide-out room against a recreational vehicle (RV) and guard against water finding its way into the vehicle. Try one of our standard options or contact an engineer for a custom solution today! We look forward to serving you!

Note: Wipers are restricted in most applications to the flange being parallel to the sealing surface and are only recommended to turn corners in the direction shown to the right.

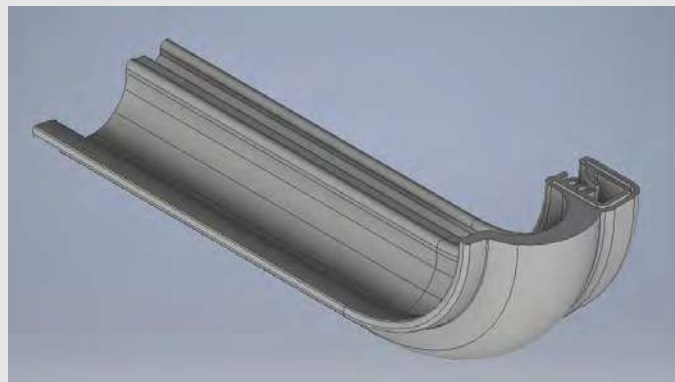

NOT FINDING YOUR PROFILE?

CONTACT US FOR YOUR CUSTOM DESIGN NEEDS

SALES@FLEXSEALS.COM • (763) 777-8037

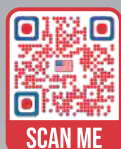

PART NO.	#3555	PART NO.	#3556
			
FLANGES	3/64" - 3/32"	FLANGES	3/64" - 3/32"
PART NO.	#3409	PART NO.	#3287
			
FLANGES	3/64" - 3/32"	FLANGES	1/16" - 1/8"

PROFILES IN STOCK AND READY TO SHIP TODAY!

DENSE EDGE

Dense edge trim is a straight-forward product made from dense EPDM rubber or PVC which can be strengthened by a steel wire core/clip. Our dense edge trim provides a finished appearance and edge protection that protects people from injury and the equipment from damage. It is fastened by pressing it into place over the edge of a door, hatch, truck/tractor cab, and other machinery or equipment. Dense edge trim can also have adhesive injected into the channel. Choose from our wide selection of trim seals for your many sealing applications. Try one of our standard options or contact an engineer for a custom solution today! We look forward to serving you!



NOT FINDING YOUR PROFILE?

CONTACT US FOR YOUR CUSTOM DESIGN NEEDS

SALES@FLEXSEALS.COM • (763) 777-8037

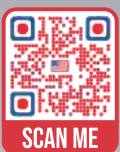

PART NO. #3108	PART NO. #3454	PART NO. #3573
FLANGES 1/8" - 5/32"	FLANGES 1/32" - 17/64"	FLANGES 1/32" - 1/16"
PART NO. #3574	PART NO. #3569	PART NO. #3570
FLANGES 1/16" - 1/8"	FLANGES 1/8" - 3/16"	FLANGES 1/64" - 1/32"
PART NO. #3571		
FLANGES 1/16" - 1/8"		

PROFILES IN STOCK AND READY TO SHIP TODAY!

LOCKING CHANNEL

Our locking channels are EPDM window seals that function well in applications that are not exposed to gasoline, kerosene, oils, or other concentrated acids. Most of the time, locking channels are used in applications where there is a fixed window and body. These could include doors on trucks, cars, UTVs, or any other scenario that needs to hold windows in place on a metal or fiberglass body. Our locking channels are made with automotive grade EPDM and they are resistant to aging, oxygen, weather, sunlight, ozone, and acids. Try one of our standard options or contact an engineer for a custom solution today! We look forward to serving you!





NOT FINDING YOUR PROFILE?

CONTACT US FOR YOUR CUSTOM DESIGN NEEDS

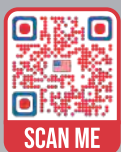
SALES@FLEXSEALS.COM • (763) 777-8037



PART NO. #3016		PART NO. #3559	
			
FLANGE 1	1/4"	FLANGE 1	7/32"
FLANGE 2	1/8"	FLANGE 2	3/32"

PROFILES IN STOCK AND READY TO SHIP TODAY!

DUAL DUROMETER

Dual durometer seams are made from EPDM rubber and they serve a plethora of applications. Dense EPDM is coextruded with sponge EPDM to provide a dense durable portion of the profile and a soft, sponge portion that provides excellent sealing capabilities. These can be fastened in multiple ways including, but not limited to; acrylic foam tape applied, “push-in” applications, and “slide in” applications. EPDM is resistant to ozone, weather, sunlight, aging, oxygen, and acids. Choose from our large selection of standard dual durometer seals or contact an engineer for a custom application today! We look forward to serving you!



NOT FINDING YOUR PROFILE?

CONTACT US FOR YOUR CUSTOM DESIGN NEEDS

SALES@FLEXSEALS.COM • (763) 777-8037

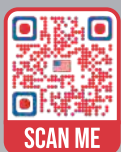

PART NO. #3304		PART NO. #1462	
			
HATS	.25"	HATS	.25"
PART NO. #3112		PART NO. #1477	
			
HATS	.25"	HATS	.375"

PROFILES IN STOCK AND READY TO SHIP TODAY!

SPONGE

We offer an extensive variety of sponge profiles to fit many applications. Sponge typically is referred to as a softer, closed cell, material. Sponge seals come in all shapes and sizes and are made of soft EPDM "Ethylene Propylene Diene Monomer" Rubber. Sponge seals offer protection of sharp edges, sealing out the elements, and they improve the aesthetics of many projects. Sponge seals are typically fastened by pushing them into a channel, onto a flange, or through adhesion with acrylic foam tape. Choose from our large selection of standard sponge seals or contact an engineer for a custom application today! We look forward to serving you!

Note: See page 4 for adhesive and bonding

FS USA can add adhesive to many of our standard extrusions to accommodate applications where mechanical 'clamp-on' or 'push-in' seals are not suitable. Our adhesives can bind our extrusions to a variety of substrates. We offer two main types of standard adhesives. Acrylic Foam Tape is a heat activated automotive grade adhesive. This provides industry leading performance and bond strength to many different substrates. Acrylic Foam tape does require a 12-24hr dwell time to bond permanently to the application, which allows for flexibility in the installation.

Our rubber-based pressure sensitive adhesive is a great option for applications needing more initial tack. This will bond quickly but lacks in long term performance in comparison to the acrylic foam tape. This performs well in applications that are more static in nature.



NOT FINDING YOUR PROFILE?
CONTACT US FOR YOUR CUSTOM DESIGN NEEDS

SALES@FLEXSEALS.COM • (763) 777-8037

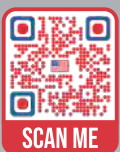



6551 Jansen Ave NE Suite 206 • Albertville, MN 55301, USA
sales@flexseals.com • (763) 777-8037 • www.flexseals.com





PART NO. #3137	PART NO. #3162	PART NO. #1146
		
TAPE .25"	TAPE .5"	TAPE .5"
PART NO. #3049	PART NO. #3164	PART NO. #3156
		
TAPE .5"	TAPE .5"	TAPE .5"
PART NO. #1840	PART NO. #3348	PART NO. #4008
		
TAPE .5"	TAPE .5"	TAPE .375"

PROFILES IN STOCK AND READY TO SHIP TODAY!

SPONGE

PART NO. #3251	PART NO. #3054	PART NO. #4009
		
TAPE .5"	TAPE .375"	TAPE .375"
PART NO. #3136	PART NO. #1599	PART NO. #3052
		
TAPE .5"	TAPE .375"	TAPE .625"
PART NO. #3166	PART NO. #3250	PART NO. #3027
		
TAPE .625"	TAPE .75"	TAPE .5"

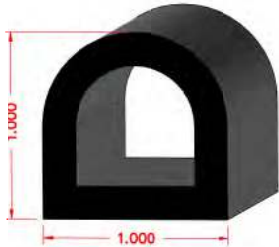

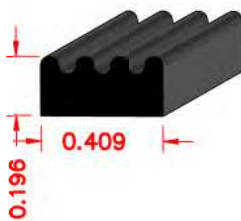
PART NO. #3291	PART NO. #3484	PART NO. #3534
		
TAPE .25"	TAPE .625"	TAPE .5"
PART NO. #3572	PART NO. #3293	PART NO. #3563
		
TAPE .75"	TAPE .5"	TAPE .5"
PART NO. #3564	PART NO. #3558	
		
TAPE .375"	TAPE .25"	

PROFILES IN STOCK AND READY TO SHIP TODAY!

EPDM EDGE

EPDM stands for “Ethylene Propylene Diene Monomer” in which density can vary slightly. Our EPDM edge trims are a great solution for anyone looking to cover a sharp edge or improve aesthetics on any project. EPDM edge trims are fastened via “push in” or “push on” applications to more complicated engineered designs with clips and bulbs included. Choose from our large selection of standard EPDM edge trim seals or contact an engineer for a custom application today! We look forward to serving you!



NOT FINDING YOUR PROFILE?

CONTACT US FOR YOUR CUSTOM DESIGN NEEDS

SALES@FLEXSEALS.COM • (763) 777-8037



PART NO. #3095		PART NO. #3093	
			
FLANGES	3/64" - 3/32"	FLANGES	3/64" - 3/32"
PART NO. #3094			
			
FLANGES	3/64" - 3/32"		

PROFILES IN STOCK AND READY TO SHIP TODAY!

PVC EDGE

PVC stands for "Polyvinyl Chloride." Our PVC edge trims are a great solution for anyone looking to cover a sharp edge or improve esthetics on any project. PVC edge trims can vary from simple "push in" or "push on" seals to more complicated engineered designs with clips and bulbs included. Choose from our large selection of standard PVC edge trim seals or contact an engineer for a custom application today! We look forward to serving you!

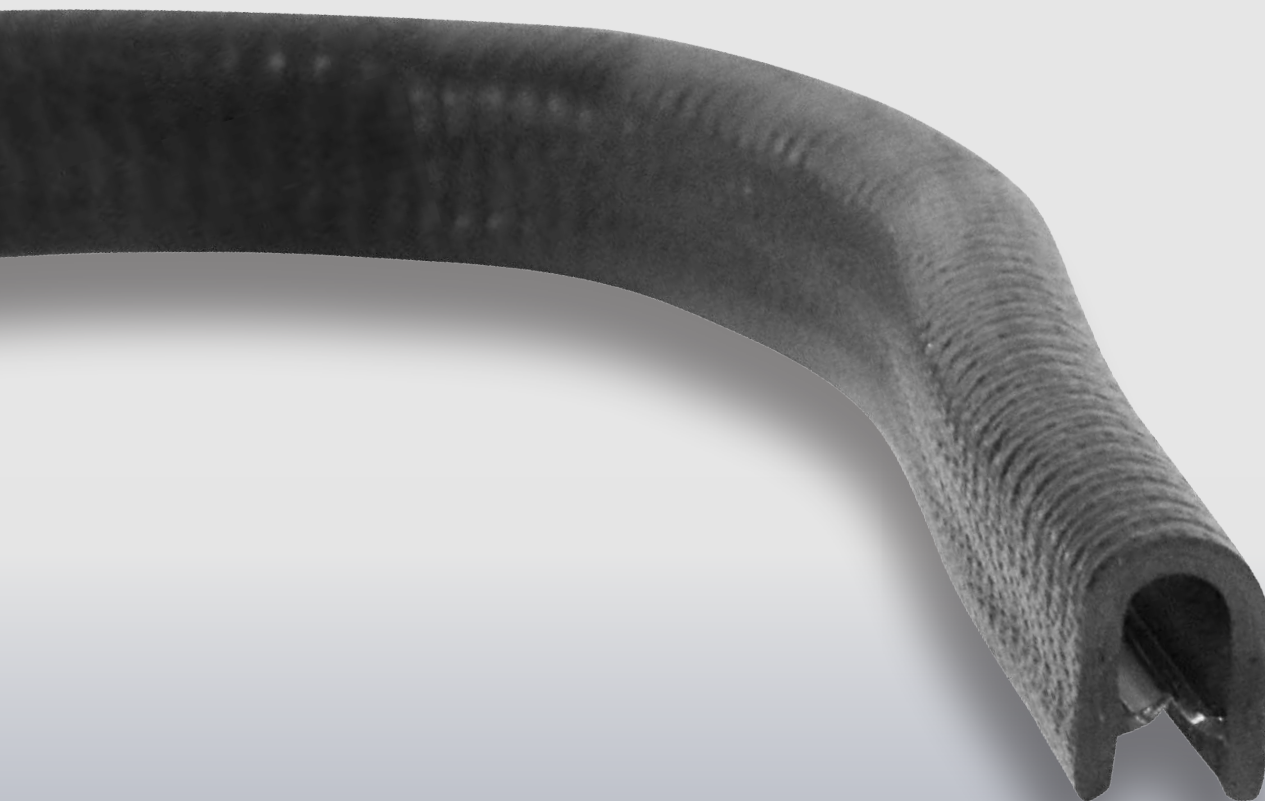

NOT FINDING YOUR PROFILE?

CONTACT US FOR YOUR CUSTOM DESIGN NEEDS

SALES@FLEXSEALS.COM • (763) 777-8037

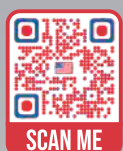

PART NO. #3139		PART NO. #3029		PART NO. #3082	
					
FLANGE	1/32"	FLANGES	1/32" - 1/8"	FLANGES	1/8" - 3/16"
PART NO. #3317		PART NO. #3081		PART NO. #3557	
					
FLANGES	5/16" - 13/32"	FLANGES	1/8" - 3/16"	FLANGES	1/32" OR LESS

PROFILES IN STOCK AND READY TO SHIP TODAY!

WHO WE ARE

RELATIONSHIPS MATTER

WE GREATLY VALUE RELATIONSHIPS AND THE OPPORTUNITIES THAT WE HAVE BEEN GIVEN TO ADD VALUE TO OUR CUSTOMERS, TEAMMATES, VENDORS, AND FAMILY MEMBERS.

GETTING THINGS DONE

TRIM SEALS IS A TALENTED GROUP OF PEOPLE THAT HAVE BEEN LEADERS IN THE RUBBER AND PLASTICS INDUSTRY SINCE 1995.

TRIM SEALS HAS BECOME A PREFERRED SOURCE FOR MISSION CRITICAL EXTRUDED, DIE-CUT, AND MOLDED FLEXIBLE PRODUCT SOLUTIONS.



DAN GRAY

Director of Quality/Operational Support



DAVID JOSEPH

Player/Business Development



JORDAN JOSEPH

Marketing Specialist



RAY HAWLEY

Director of Creative Solutions



PAUL BOWDEN

Director of Leadership Development



PHIL GUDIM

Customer Relations Specialist



BECCA STOLARCZYK

Customer Relations Specialist



JULIA NAGORSKI

Customer Relations Specialist



COLLEEN STOMMES

Customer Relations Specialist



TRIM SEALS ***DIRECT***

by
FSUSA

**MADE
IN
AMERICA**

HOW TO ORDER
VISIT

FLEXSEALS.COM

TRIM SEALS ***DIRECT***
by
FSUSA

GREAT PEOPLE PROVIDING HIGH QUALITY PARTS ON TIME, EVERY TIME.



FS USA DIFFERENCE

- 1) A PARTNER IN APPLICATION SUPPORT AND ENGINEERING
- 2) PROUDLY MANUFACTURING IN THE USA
- 3) LARGEST STANDARD TOOLING CATALOG IN THE INDUSTRY
- 4) INDUSTRY LEADER IN QUALITY AND SERVICE
- 5) WE MANUFACTURE ALL TYPES OF EXTRUDED SOLUTIONS:
 - RUBBER
 - PLASTIC
 - SINGLE DUROMETER
 - MULTIPLE DUROMETER
 - WIRE & METAL ENCAPSULATED
 - FRAMING, GASKETING & FINISHING
- 6) IN HOUSE TOOLING SHOP
- 7) PRIVATELY HELD WITH ACTIVE MANAGEMENT
- 8) INDUSTRY LEADER IN SERVICE WITH OVER 20 YEARS TOGETHER
- 9) MULTIPLE SERVICE LOCATIONS OF MN, GA, IN & OH
- 10) WORLD WIDE COMPANY WITH U.S. FOCUS



HOW TO ORDER

VISIT

FLEXSEALS.COM



6551 Jansen Ave NE Suite 206 • Albertville, MN 55301, USA
sales@flexseals.com • (763) 777-8037 • www.flexseals.com